

# Technical Manual and Replacement Parts List

---

## Imperial Milk Dispensers



**MODEL SK1 IMPERIAL**



**MODEL SK2 IMPERIAL**



**MODEL SK3 IMPERIAL**

### **SILVER KING REFRIGERATION INC.**

1600 Xenium Lane North, Minneapolis, MN 55441-3787  
Phone (763) 923-2441





## TECHNICAL MANUAL

### SILVER KING BULK MILK DISPENSERS

Thank you for purchasing Silver King food service equipment. Our goal is to provide our customers with the most reliable equipment in the industry today. Please read this manual and the accompanying warranty information before operating your new Silver King unit. Be sure to complete and mail the warranty card within 10 days of purchase.

Upon delivery of your new Silver King unit, inspect the carton and unit for shipping damages. Report any damage immediately to the transportation carrier and file a written freight damage claim to protect your investment.

#### INSTALLATION

The stainless steel exterior of the cabinet has been protected by a plastic covering during manufacturing and shipping. This covering can be readily peeled before installation. After removing this covering, wash the interior and exterior surfaces using a warm mild soapy water solution and a sponge or cloth.

#### Location:

When locating your new milk dispenser, convenience and accessibility are important considerations, but the following factors must be observed:

- When placing the unit on a counter, the counter must be able to support a minimum of 350 pounds.
- When wall mounting the unit, follow the instructions supplied with the wall mounting kit.
- When placed on a counter, the unit must be on the legs supplied **and** secured to the counter with the Hold Down Brackets supplied. If the legs are not installed the unit will not operate properly and the warranty will be void.
- The vent at the top rear of the unit must not be blocked as this serves as an outlet for circulating air. There must be at least four (4) inches of clear space above the unit.
- Correct serving height is important so that those using the dispenser can operate the dispenser properly.
- The unit must be level.
- Avoid placing the unit next to an oven, heating element or hot air source, which would adversely affect the performance of the unit.

#### Electrical Connections:

Be sure to check the data plate, located on the liner of the cabinet, for required voltage prior to connecting the unit to power. The specifications on the data plate supersede any future discussion.

The standard dispenser is equipped with an eight (8) foot power cord that requires a 115 Volt, 60 Cycle, 1 Phase **properly grounded** electrical receptacle. The power cord comes with a 3 prong plug for grounding purposes. Any attempt to cut off the grounding spike or to connect to an ungrounded adapter plug will void the warranty, terminate the manufacturers responsibility and could result in serious injury.

The circuit must be protected with a 15 or 20 ampere fuse or breaker.

#### OPERATION

##### Initial startup:

After satisfying the installation requirements, the milk dispenser is ready to start. The unit will start when the power cord is connected to a live electrical receptacle. If the compressor and condenser fan are not running when the unit is initially plugged in, check to make sure that the Temperature Control is not set to the 'off' position. Allow the unit to run a minimum of one hour before loading it with product.

##### Preparation For Use:

After the unit has achieved proper operating temperature, observe the following procedures for preparing the unit to dispense milk:

- Place a full, previously cooled, milk container in the unit and locate it over the Valve so the dispensing tube lines up with the Valve.
- Remove the plastic film covering the dispensing tube if supplied.
- With the Valve installed in the Valve Holder, open the Valve by lifting the weight and feed the dispensing tube through the tube passage in the Valve. Refer to the label on the door liner for a graphic view of this procedure.
- Allow the Valve to close thus pinching the dispensing tube closed.
- Cut the dispensing tube with a knife or scissors approximately one (1) inch below the pinch point of the Valve.
- Close and latch the dispenser door.
- To dispense milk, place a glass under the dispensing tube and lift the valve.

**Temperature Control:**

The Temperature Control, located on the lower left side of the cabinet, is factory set at the midpoint position, #4, which will maintain an average product temperature of about 37 Deg F. To obtain cooler temperatures, use a flat tip screwdriver to turn the Temperature Control clockwise and visa versa. Allow the unit a minimum of six (6) hours to respond to a control setting adjustment if the product is in the cabinet.

**Temperature Indicator:**

The Temperature Indicator, mounted on the door, is factory set to indicate the temperature of the product within two (2) degrees. Should the Temperature Indicator read inaccurately there are instructions for re calibrating it located on the door liner.

**Defrost:**

The Silver King milk dispenser is a manual defrost unit. The unit should be defrosted whenever the walls accumulate a frost/ice bank that is 1/2 inch thick. To defrost the unit, either turn the Temperature Control knob to the 'off' position or disconnect the power cord from the electrical receptacle, and open the door. After the frost/ice has melted or come loose from the cabinet walls, wipe out the cabinet interior. Do not attempt to scrape or chisel off the frost/ice as you could do irreparable damage to the unit.

**MAINTENANCE**

Preventative maintenance is minimal although these few steps are very important to continued operation and maximizing the life of the appliance.

**Cabinet Surfaces:**

The cabinet interior and exterior are stainless steel and should be cleaned periodically with a solution of warm water and a mild soap and wiped dry with a clean soft cloth. Should a surface become stained or discolored, do not attempt to clean with an abrasive cleaner or scouring pad. Use a soft cleaner and rub with the grain of the metal to avoid scratching the surface.

**Valves and Valve Holders:**

Remove the Valves and Valve Holders from the unit and clean with warm soapy water. Do not place them in the dishwasher for cleaning.

**Leaking Valves:**

Should you encounter a situation where a Valve is steadily leaking or dripping milk, the problem can be remedied by making sure that the dispensing tube runs straight down from the milk container to the pinch point of the Valve. If the tube has to bend before the pinch point it tends to 'walk' around the pinch point as you operate the Valve. One way to eliminate this problem is to raise the milk container in the cabinet by placing it on Platform Extension (part number 61942) which you can obtain from your local Silver King Inventory Center.

**Condenser:**

Periodically, accumulated dust on the condenser should be removed. First, disconnect the unit from the power supply. Remove the back panel to expose the condenser. Remove the accumulated dust by vacuuming or brushing it. Proper maintenance will reduce energy consumption and extend compressor life.

MODEL \_\_\_\_\_ SERIAL NO. \_\_\_\_\_ DATE INSTALLED \_\_\_\_\_

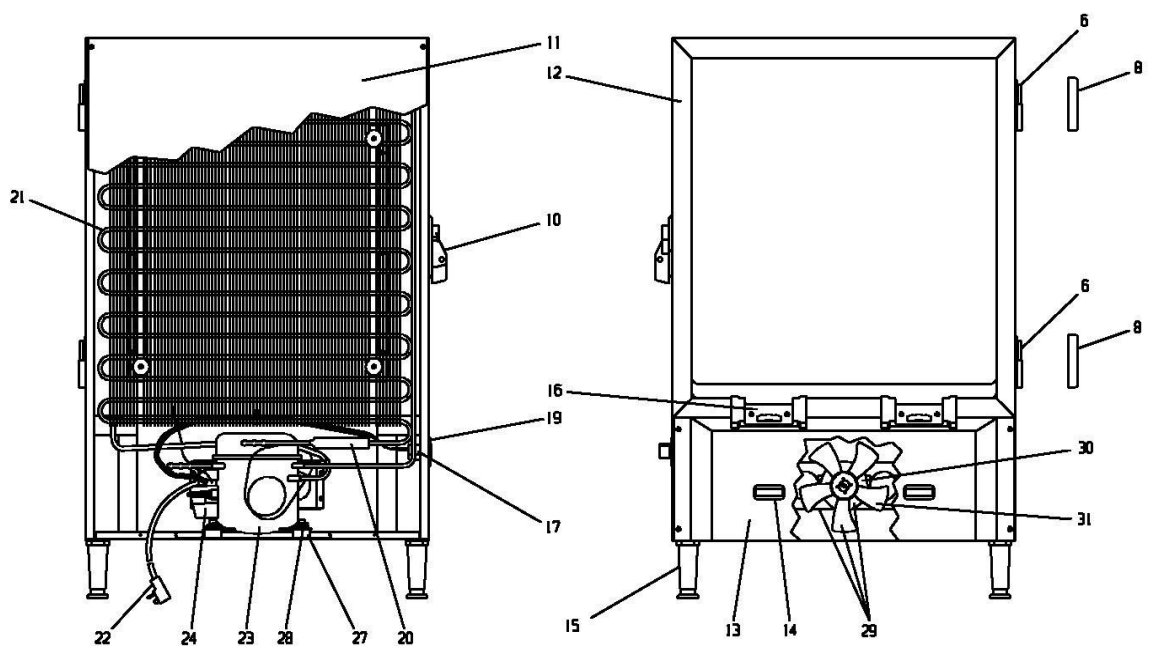
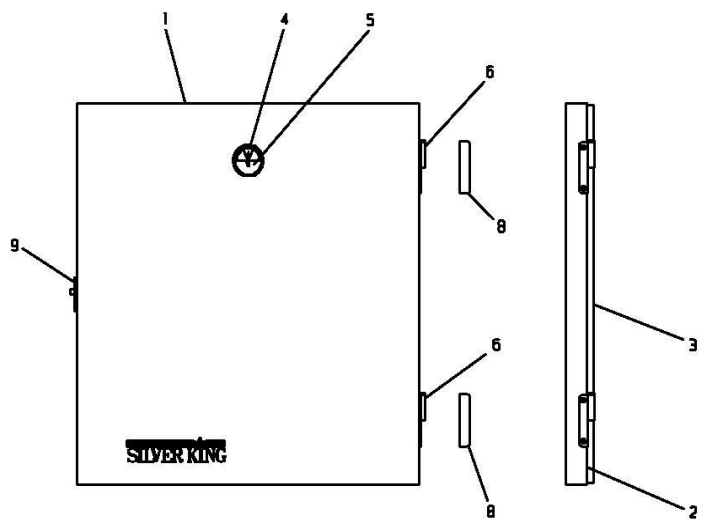

SK2IMP SHOWN

## REPLACEMENT PARTS LIST: IMPERIAL MILK DISPENSERS

ITEM NO.	PART DESCRIPTION	MODEL NUMBER		
		SK1IMP	SK2IMP	SK3IMP
1	DOOR, COMPLETE	10335-05	10335-08	10335-11
2	DOOR LINER (NOT SHOWN)	20405	40367	40370
3	DOOR GASKET	10310-07	10310-08	10310-09
4	TEMPERATURE INDICATOR	20361	20361	20361
5	LENS REPLACEMENT - TEMP. INDICATOR	22986	22986	22986
6	HINGE ASSY (BOTH HALVES AND COVERS)	10327-09	10327-09	10327-09
8	HINGE COVER	21758	21758	21758
9	DOOR STRIKE	21073	21073	21073
10	DOOR LATCH	21069	21069	21069
11	BACK PANEL	40445	40444	40443
12	BREAKER STRIP	60326	60327	60328
13	APRON	23088	20428	20446
14	GLASS LOCATOR	21074	21074	21074
15	KIT LEG 4" ADJUSTABLE	10314-61	10314-61	10314-61
16	VALVE WELL INSERT	60906	60906	60906
17	TEMPERATURE CONTROL	43064	43064	43064
19	PLATE, TEMPERATURE CONTROL	20653	20653	20653
20	DRIER	22677	22677	22677
21	CONDENSER COIL	62796	63024	62773
22	POWER CORD (115V)	22099	22099	22099
	POWER CORD (230V)	23038	23038	23038
23	COMPRESSOR (115V 60 HZ)	10343-51	10343-02	10343-40
	COMPRESSOR (230V 50HZ)	10343-24	10343-78	10343-32
	COMPRESSOR (230V 60HZ)	10343-78	10343-78	10343-64
24	ELECTRICAL KIT (115V) (RELAY AND OVERLOAD)	10344-51	10344-02	10344-40
	ELECTRICAL KIT (230V 50HZ)	10344-24	10344-78	10344-32
	ELECTRICAL KIT (230V 60HZ)	10344-78	10344-78	10344-64
27	GROMMET, COMPRESSOR MOUNT	20481	20481	20481
28	CLIP, HAIRPIN	98106	98106	98106
29	FAN MOTOR ASSEMBLY (115V)	42822	42814	42814
	FAN MOTOR ASSEMBLY (230V)	42822-01	42814-01	42814-01
30	FAN MOTOR (115V)	21251-2	22048	22048
	FAN MOTOR (230V)	21251-3	43193	43193
31	FAN BLADE	22974	99228	99228

WHEN ORDERING REPLACEMENT PARTS, PLEASE PROVIDE MODEL AND SERIAL NUMBERS

## NO. 60CG VALVE

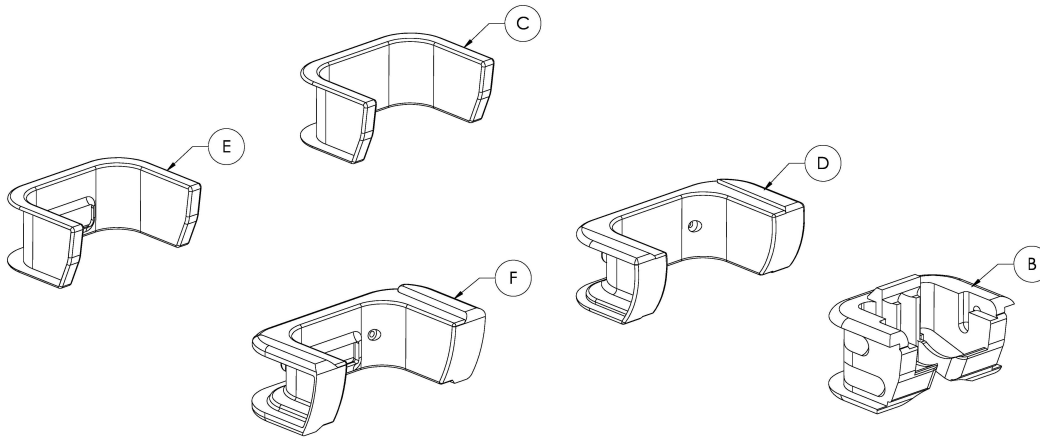

### NO. 60CG VALVE

- A. 27922 60CG VALVE ASSEMBLY
- B. 27426 VALVE HOLDER
- C. 40013 MOLDING CLOSURE
- D. 60936 MOLDING CLOSURE
- E. 40712 MOLDING CLOSURE
- F. 60906 MOLDING CLOSURE

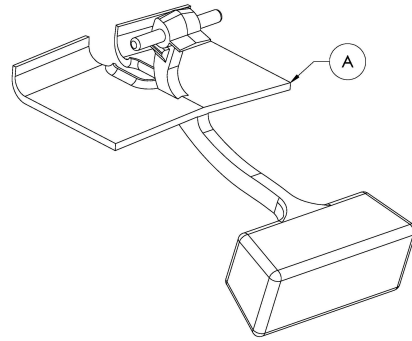

30906 REV A

## NO. 40H VALVE

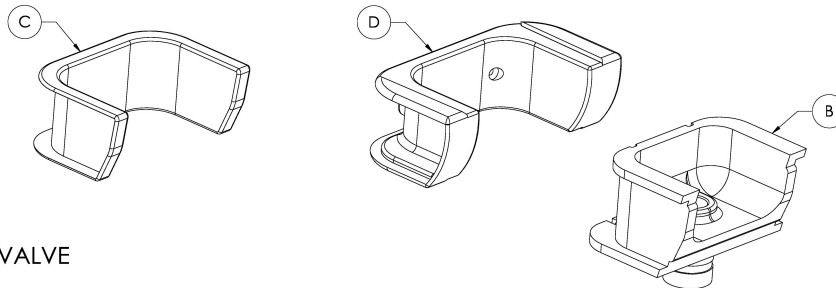

### NO. 40H VALVE

- A. 20305: 40H VALVE ASSEMBLY  
(COMPLETE)
- VALVE PARTS:
  - 1. 60067 VALVE BODY
  - 2. 20298 SET SCREW
  - 3. 20306 SLIDE
  - 4. 60128 VALVE ARM
  - 5. 20299 SHOULDER SCREW
- B. 60016-2: VALVE HOLDER
- C. 40013: MOLDING CLOSURE
- D. 60936: MOLDING CLOSURE

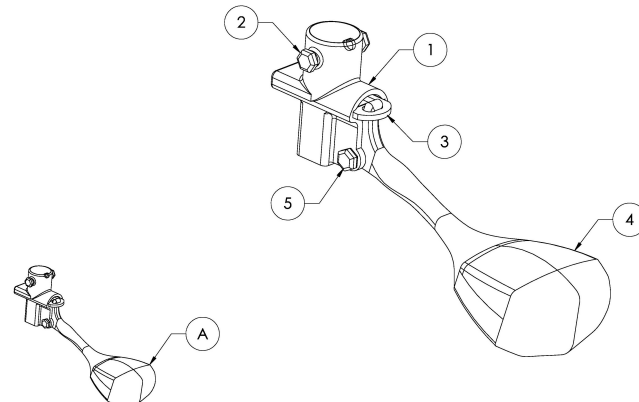

30905 REV A

